

## TECHNICAL SPECIFICATION

### Tariff switching clock (timer) TE 18



#### Description:

The timer is adjusted for DIN-rail mounting. It is used for switching on tariff lighting in housing buildings and switching off after the adjusted time. Easy to adjust time intervals, mounting and conducting. Reliable to use.

#### Technical data:

- Power supply voltage: 230V; 50Hz
- Adjustment range: 0.5 to 20 min
- Power consumption: <2.5VA
- Operating temperature: -5 ÷ +65°C
- Humidity: 45 – 95%RH
- Number of contacts: 1NO
- Commutating capacity:
  - active load: up to 16A
  - inductive load: up to 10 A
- Weight: 120g

#### Mounting:

- DIN-rail

**Dimensions:**

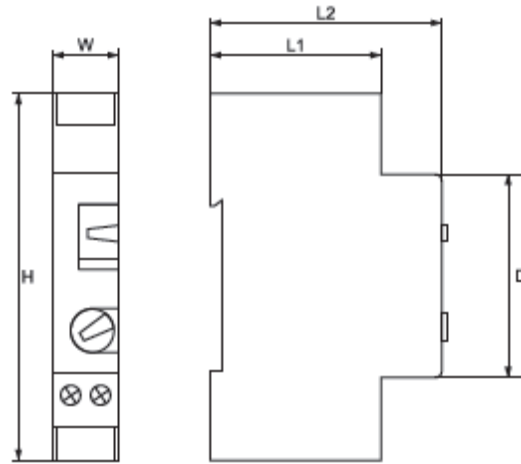

| H  | W  | L1 | L2 | D  |
|----|----|----|----|----|
| 82 | 18 | 40 | 65 | 45 |

| Type  | Packing / Box (pcs) | Catalogue number |
|-------|---------------------|------------------|
| TE 18 | 1 / 200             | 35005            |

Standards: EN 61812-1  
EN 60730-7

